



OWNER OF PROPERTY: _____

Mailing address _____

City _____ State _____ Zip _____

Phone _____

Email _____

Tenant/Lessee: _____

Contact Phone _____

GENERAL CONTRACTOR: _____

Johnson County License # _____ Class _____ Edgerton Business License # _____

Contact Name _____

Contact Phone _____

Address _____ City _____ State _____ Zip _____

Email _____ Fax _____

Valuation of Improvement \$ _____

BUILDING SITE ADDRESS: _____

City _____ State _____ Zip _____

TYPE OF WORK:

- | | | | | |
|---------------------------------------|-----------------------------------|-------------------------------------|---|--------------------------------------|
| <input type="checkbox"/> New building | <input type="checkbox"/> Addition | <input type="checkbox"/> Alteration | <input type="checkbox"/> Repair/replace | <input type="checkbox"/> Demolition |
| <input type="checkbox"/> Deck/porch | <input type="checkbox"/> Canopy | <input type="checkbox"/> Car port | <input type="checkbox"/> Pool/hot tub | <input type="checkbox"/> Other _____ |

Check characteristics of building-Principal Type

Foundation: ☐ Poured concrete ☐ Block ☐ Other _____

Construction Materials: ☐ Wood frame ☐ Brick Veneer ☐ Masonry ☐ Structural Steel ☐ Other _____

Roofing: ☐ Wood ☐ Composition ☐ Concrete ☐ Metal ☐ Other _____

Note: The 2006 International Building, Residential, Fuel Gas, Plumbing, Mechanical, Existing, Fire Codes and 2005 National Electric Code are adopted by the City, Ord. No. 891

TYPE OF PERMIT:

- | | | | |
|--|---------------------------------------|--|---------------------------------------|
| <input type="checkbox"/> New Single Family | <input type="checkbox"/> Multi Family | <input type="checkbox"/> Accessory Building* | <input type="checkbox"/> Plumbing |
| <input type="checkbox"/> HVAC | <input type="checkbox"/> Electrical | <input type="checkbox"/> Fuel Gas | <input type="checkbox"/> Other: _____ |

*Please attach a drawing of the accessory structure to this application. See last page for example.

FOR OFFICE USE ONLY

Parcel ID _____ Zoned _____

Date _____

Building Permit # _____

Zoning ☐ Approved ☐ Rejected

Code

Flood Plain ☐ Yes ☐ No

Permit Fee \$ _____

BLDGPERMIT

Plumbing, Mechanical, Electrical, Fuel Gas \$50.00

Plan Review \$ _____

PRMREVFEE

(if applicable)

Water System Connection Fee \$ _____

NEWINSTALL

Water System Dev Fee \$ _____

SYSDEVFEE

Wastewater Connection Fee \$ _____

SEWCON

Wastewater System Dev Fee \$ _____

SEWDEVFEE

Park Impact Fee \$ _____

PARKFEE

Utility Application Fee \$ _____

SERVAPPIN

Total Fees \$ _____

Receipt # _____

Date Permit Issued: _____ **Date Permit Closed:** _____

Building Official Signature: _____



SUBCONTRACTOR INFORMATION

Plumbing Company: _____

Contact Name _____ Phone _____ Email _____

Johnson County License # _____ Edgerton Business License # _____

Mechanical Company: _____

Contact Name _____ Phone _____ Email _____

Johnson County License # _____ Edgerton Business License # _____

Electrical Company: _____

Contact Name _____ Phone _____ Email _____

Johnson County License # _____ Edgerton Business License # _____

Framing Company: _____

Contact Name _____ Phone _____ Email _____

Johnson County License # _____ Edgerton Business License # _____

Foundation Company: _____

Contact Name _____ Phone _____ Email _____

Johnson County License # _____ Edgerton Business License # _____

Roofing Company: _____

Contact Name _____ Phone _____ Email _____

Johnson County License # _____ Edgerton Business License # _____

Roofing Contractor Registration Certificate # _____

UTILITIES: ☐ Water ☐ Sewer ☐ Electric ☐ Gas

Electric service size: _____ Sewer Permit # _____ Septic Permit # _____

Water Meter size, if new: _____

Building Area: New construction sq. ft. _____ Remodel sq. ft. _____

NOTES: _____

Signature of owner _____ **Date** _____

Signature of contractor _____ **Date** _____

Example of drawing for an Accessory Structure (shed or fence)

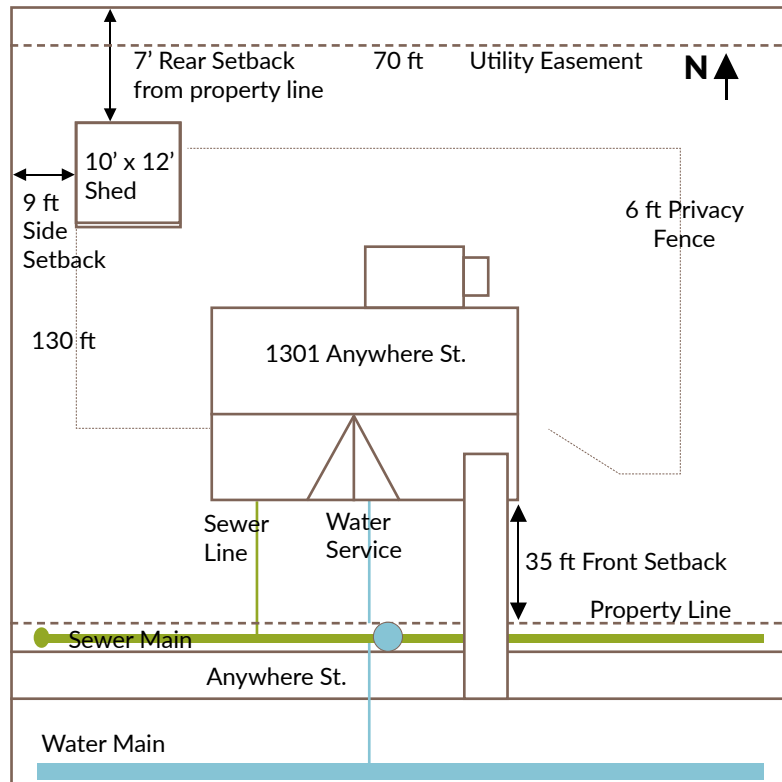

Provide a drawing of your proposed improvement

New single and Multi-family structures require a certified plot plan from a licensed engineer.

Drawing must include:

- Location of property lines
- Distance between property lines, accessory use and primary structure (home)
- Easements
- Right of way lines
- Utility lines
- Existing fencing and sidewalks

NOTE: The City of Edgerton does not perform or require property surveys. The approval of a permit by the City does not in any way absolve the owner from the requirement to ensure that accessory structures are fully contained within their property lines and not placed over an easement or right of way. Be advised that placing your accessory structure in an easement or right of way may result in the future removal at the property owner's expense.